

EXCALON TRAFFIC MANAGEMENT

NOTES

1. ALL SIGNS ARE AS PER CHAPTER 8.
2. DISTANCE BETWEEN SIGNS ARE NOT TO SCALE AND ARE FOR LAYOUT PURPOSES ONLY.
3. SIGNS SHOULD BE POSITIONED IN A SAFE WORKING SPACE.

KEY

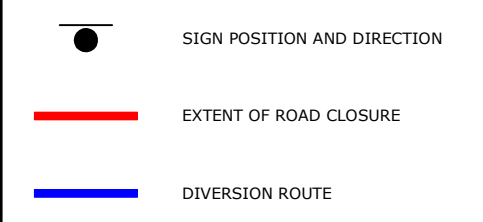

SIGN	QUANTITY
	X 2
	X 4
	X 1
	X 12
	X 4
	X 3
	X 8
	X 3
	X 1
	X 1
	X 1
	X 1
	X 4
	X 2
	X 8
	X 1
	X 2

EXCALON HEAD OFFICE
 SANDPIPER COURT, 20 MODWEN ROAD,
 WATERS EDGE BUSINESS PARK,
 SALFORD QUAYS, MANCHESTER,
 M5 3EZ



PROJECT
 DS68

DRAWING
 STYAL ROAD,
 WILMSLOW, SK9 4AQ,
 ROAD CLOSURE / DIVERSION

DRAWN BY:	CM	DATE:	11/08/17
CHECKED BY:	BM	DATE:	11/08/17
APPROVED BY:	ML	DATE:	11/08/17
DRAWING No.	REV3	REVISION	3

DO NOT SCALE FROM THIS DRAWING

